

THIS PARTS LIST APPLIES TO ASSEMBLIES AT REVISION LEVEL G (AS OF 6-7-2011) AND LATER.
FOR PRIOR ASSEMBLY REVISIONS REFERENCE SHEET 2 OF THIS PARTS LIST.

THIS PARTS LIST CONTAINS 2 SHEETS.

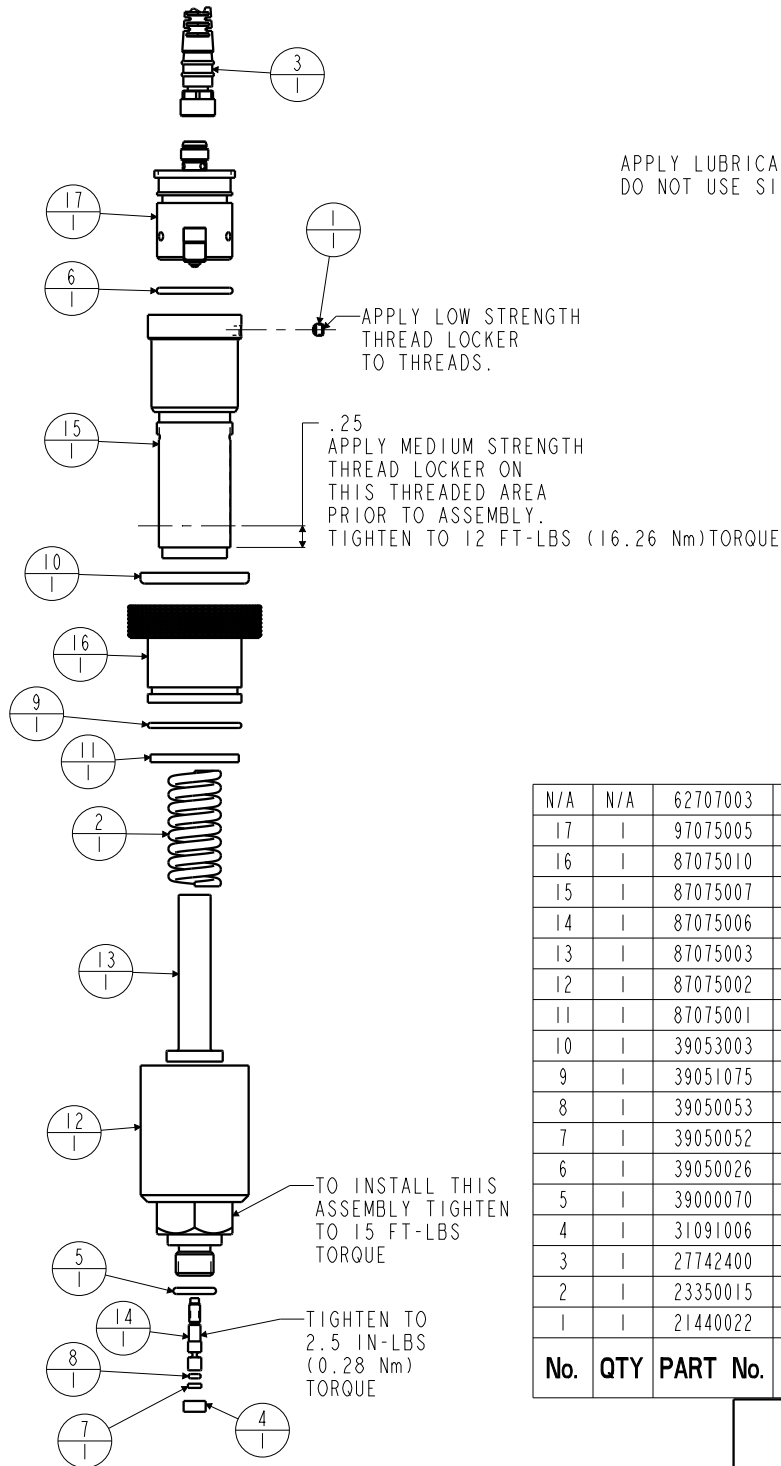

APPLY LUBRICANT TO ALL SEALS PRIOR TO INSTALLATION
DO NOT USE SILICONE TYPE LUBRICANTS.



N/A	N/A	62707003	KIT, REPAIR, SWITCH, PRESS	NOTED
17	1	97075005	ASSY, SWITCH, PRESS, M8	X
16	1	87075010	ADJUSTER, SWITCH, PRESSURE, SEVERE	
15	1	87075007	COLLAR, SWITCH, PRESSURE	
14	1	87075006	PIN, STROKE, SWITCH, PRESSURE	
13	1	87075003	PLUNGER, SWITCH, PRESSURE	
12	1	87075002	BODY, SWITCH, PRESSURE	
11	1	87075001	SHIM, ENDED, DOUBLE	
10	1	39053003	WIPER,PRESS-IN, (1)	
9	1	39051075	O-RING, (24.5mm x 1.5)	
8	1	39050053	O-RING, (-002)	
7	1	39050052	SEAL, PIN, STROKE, SWITCH, PRESS	
6	1	39050026	O-RING, (-018)	X
5	1	39000070	O-RING, (-904)	X
4	1	31091006	FILTER, BRONZE, SINTERED, .250, 150µ	
3	1	27742400	CORDSET, MALE, FEMALE, M8, 0.5M	
2	1	23350015	SPRING, COMPRESSION	
1	1	21440022	SHSS, CUP POINT	
No.	QTY	PART No.	DESCRIPTION	Included in Repair Kit

PARTS LIST



VEKTEK, INC.
1334 E. SIXTH AVE. P.O. BOX 625
EMPORIA, KS. 66801 U.S.A.

C	5303	RELEASE	JDW	05/01/24
REV	IN ACCORDANCE WITH ECN	EFFECTIVE DATE	REVISED BY	DATE
DRW BY:	DKC	DRAWING STATUS: Released		
DATE:	6-6-11	PRODUCTION APPROVED FOR RELEASED STATUS ONLY		

ASSEMBLIES AFFECTED
70-7500-76

PARTS LIST, ASSY, SWITCH, PRESS, 0.5M CABLE	
SIZE A	PL7115
REV C	

FORM FEG035_PL_ASIZE, REV. B

SHEET 1 OF 2

THIS PARTS LIST APPLIES TO ALL ASSEMBLIES PRIOR TO REVISION LEVEL G (6-7-11 AND EARLIER).

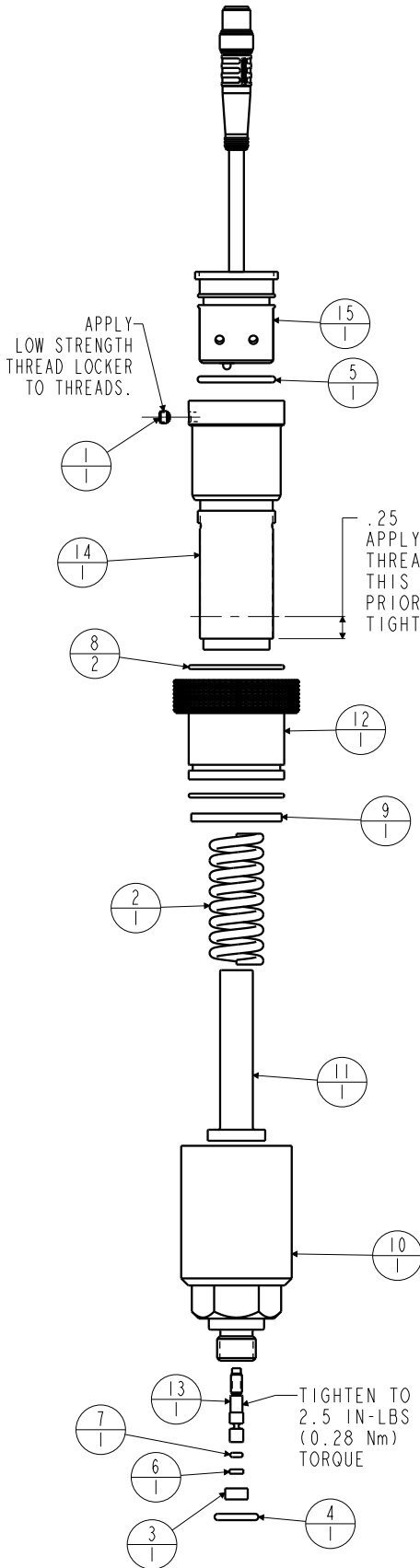

APPLY LUBRICANT TO ALL SEALS PRIOR TO INSTALLATION
DO NOT USE SILICONE TYPE LUBRICANTS.



NOTE: 97-0750-03 REPLACED BY 97-0750-05.
ORDER CORD 27-7424-00 AND REPAIR
KIT 62-7020-03 FOR REPLACEMENT

No.	QTY	PART No.	DESCRIPTION	Included in Repair Kit
N/A	N/A	62707003	KIT, REPAIR, SWITCH, PRESS	
-	1	97075005	ASSY, SWITCH, PRESS, M8	X
15	1	97075003	ASSY, SWITCH, PRESS, PUMP	
14	1	87075007	COLLAR, SWITCH, PRESSURE	
13	1	87075006	PIN, STROKE, SWITCH, PRESSURE	
12	1	87075005	ADJUSTER, SWITCH, PRESSURE	
11	1	87075003	PLUNGER, SWITCH, PRESSURE	
10	1	87075002	BODY, SWITCH, PRESSURE	
9	1	87075001	SHIM, ENDED, DOUBLE	
8	2	39050054	O-RING, (.990 x .045)	
7	1	39050053	O-RING, (-002)	
6	1	39050052	SEAL, PIN, STROKE, SWITCH, PRESS	
5	1	39050026	O-RING, (-018)	X
4	1	39000024	O-RING, (-904)	X
3	1	31091006	FILTER, BRONZE, SINTERED, .250, 150µ	
2	1	23350015	SPRING, COMPRESSION	
1	1	21440022	SHSS, CUP POINT	



VEKTEK, INC.
1334 E. SIXTH AVE. P.O. BOX 625
EMPORIA, KS. 66801 U.S.A.

PARTS LIST, ASSY, SWITCH, PRESS, 14.0 IN, CONN

SIZE A PL7115

REV C

FORM FEG035_PL_ASIZE, REV. B

SHEET 2 OF 2